

Project Name:

Location:

Specifier:

Rep Agency:

Fixture Type:

Product Code:

KLIK LEDpod™ XL28 Patented

Description

Minimalist point source LED fixture with multiple outputs for use in hollow metal structures such as guard rails, awnings, canopies and bus shelters. Asymmetric and symmetric options available. Please note these fixtures are not for use in hand rail.

Housing

Clear anodized aluminum body as standard. Color-match anodized as an option, consult factory.

Aluminum body has a fine 25-micron finish and is then hard-coat anodized, thus preventing galvanic corrosion.

Mounting

Unique concealed internal mounting wings hold the fixture in place, deployed via unobtrusive screw holes with patent-pending anti-tamper screws.

- Tube Size:
 - XL28 Flat: Min. internal clearance 35mm, max. wall 7mm
 - XL28R30: Ø58mm - Ø62mm, max. wall 5mm (**For 2" Pipe**)
 - XL28R35: Ø64mm - Ø72mm, max. wall 5mm
 - XL28R40: Ø74mm - Ø86mm, max. wall 5mm
 - Custom wall thicknesses available, Consult Factory
- Cut Out: Ø28.5mm - Ø 29.5mm (1-1/8")
- Weight: 0.040kg

Electrical/LED Driver

- Input Voltage: 24 VDC
- Operating Temp: -40 to 120° F
- Efficiency: 88 lm/W
- Driver: Must use class 2 driver
 - Primary Driver: 110 - 277 VAC UL Listed Constant Voltage
 - Secondary Driver: 350 - 700mA Dimmable Constant Current (provided with fixture)
- Control: DALI, 0-10V, DMX
 - DMX control for dimming only, not for individually addressed LEDpod
- Enclosure: Minimum NEMA2 for indoor, NEMA 3R for outdoor

Listings

- ETL listed, UL 1598/CSA 22.2; CE
- cETL
- IP65 rated *All IP rated luminaires tested to AS60529-2004 Degrees of protection provided by enclosures (IP Code)*
- Class 3 device
- Wet location rated
- International Dark Sky Association Certified *(Color temperature must be Amber or less than 3000K)*



Flat



Curved

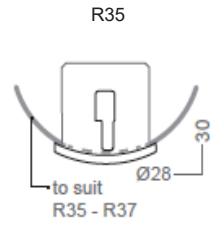

R35

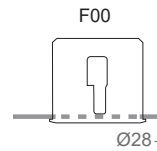

F00

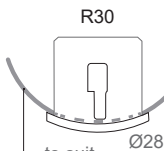

R30

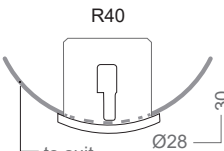

R40



Shroud

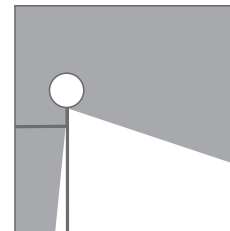
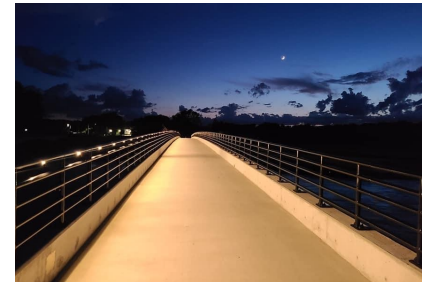

Asymmetric

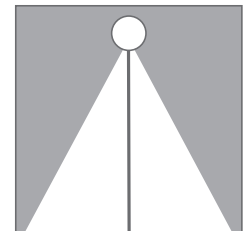

Symmetric



Product Codes

Follow the steps to specify your fixture. Enter Product Code in field at top of page. Example: LPXL28F0027K1.4AFLD

Fixture Type	Size	Bezel Profile	Color	Wattage	Distribution	Optic	Lens ^{1,2}	Custom Bezel ^{1,2}	Custom Wall ¹
LPXL LEDpod XL	28 Fits 1-1/8" Hole	F00 Flat	27K 2700K	1.4 1.4 Watts	A Asymmetric	FLD Flood	Clear lens standard FRS Frosted	DUL DULUX Colors (request color guide)	.25 For 1/4" Wall Thickness
		R30 30mmR	30K 3000K	1.9 1.9 Watts	S Symmetric			ANO Anodize	
		R35 35mmR	35K 3500K	2.5 2.5 Watts				SPC Standard Powdercoat	
		R40 40mmR	40K 4000K					SHR Diode shroud for horizontal mount	
			50K 5000K						
			RED Red						
			GRN Green						
			BLU Blue						
			AMB Amber						
			PCA PC Amber						

1. Additional charges and lead time apply for this feature.

2. Anodized bezel available, contact factory

Project Name:	Location:
Specifier:	Rep Agency:
Fixture Type:	Product Code:

LED Performance

LED: Cree XT-E
CCT: 2700, 3000, 4000 (others available)
CRI: 80-85
Life: 80% at 50k hrs and 85° C
Binning: 3 MacAdam Steps
Warranty: 5 Year Warranty

Lumens/Fixture or Pod

1.4W/POD Transparent	1.9W/POD Transparent	2.5W/POD Transparent
3000K 89	3000K 120	3000K 157
4000K 94	4000K 127	4000K 166
5000K 105	5000K 141	5000K 184

Optics			Reflector					
			XL28 Flat		XL28R35		XL28R40	
Beam Angle			Asymmetrical	Symmetrical	Asymmetrical	Symmetrical	Asymmetrical	Symmetrical
lm	W	mA	System Lumens @4000K					
120	1.4	350	89	95	85	94	85	94
162	1.9	500	120	140	117	138	117	138
212	2.5	700	157	170	152	169	152	169

Remote Mounting Distance Chart

24 VDC 100W Driver	Approximate Distance From Driver to First LED at 30 Fixtures			
Wire Size	10 AWG	12 AWG	14 AWG	16 AWG
Distance	213'	147'	82'	48'

Calculations based on 2' centers between pods at 700mA (2.5W).
Increased spacing reduces number of pods per circuit.

Primary Driver

	Secondary LED Driver	Spacing	Maximum KLIK LEDpods™ *
110 - 277 Primary Voltage Remotely Mounted Dimming Control 10" x 1.5" x 2"	700mA	2'	30
	500mA	2'	37
	350mA	2'	50

*Based on 16 AWG between LEDpods

Required Accessories

LP096WPRITRNDIM	Class 2 IP67 driver, 110-277VAC to 24VDC constant voltage, 0-10 Dim
LP100WPRITRNDIM	Class 2 Driver, Dimming, Input voltage = 120-277 VAC, Output voltage = 24 VDC, 5 year warranty
LPNEMA2ENCL	NEMA2 INDOOR enclosure for LP100WPRITRNDIM, 12" x 3.3" x 2"
LPNEMA3RENCLJR	NEMA 3R Drip Proof Enclosure, 4 x 4 x 12 (IP32 Equivalent)
LPNEMA4ENCLJR	NEMA4 Watertight Enclosure, 6 x 4 x 12 (IP66 Equivalent); NEMA4X
LPNEMA6PENCL	Available NEMA 6P Submersible Enclosure 15" x 8" x 6" (IP67 Equivalent)

Additional driver & enclosure configurations available. Please note the KLIK UL Listing requires purchase of a remote driver and enclosure.

Project Name:

Location:

Specifier:

Rep Agency:

Fixture Type:

Product Code:

KLIK LEDpod™ XL Footcandle Chart

24" Between Fixtures:

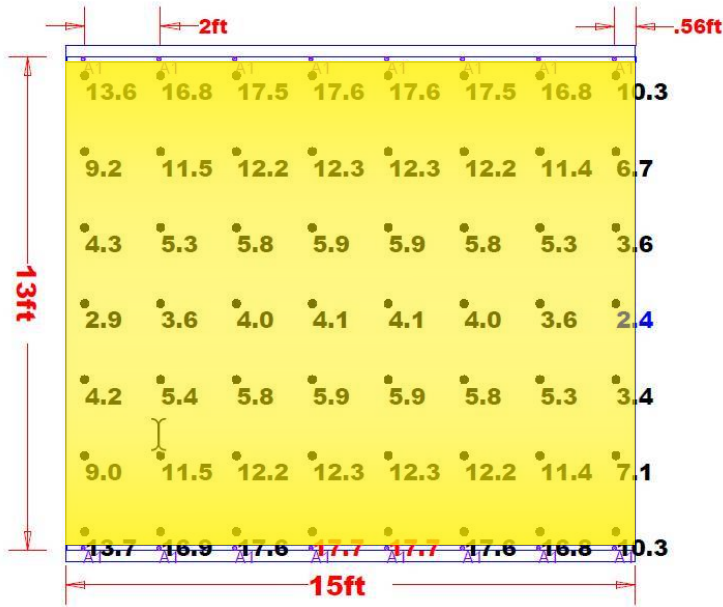

36" Between Fixtures:

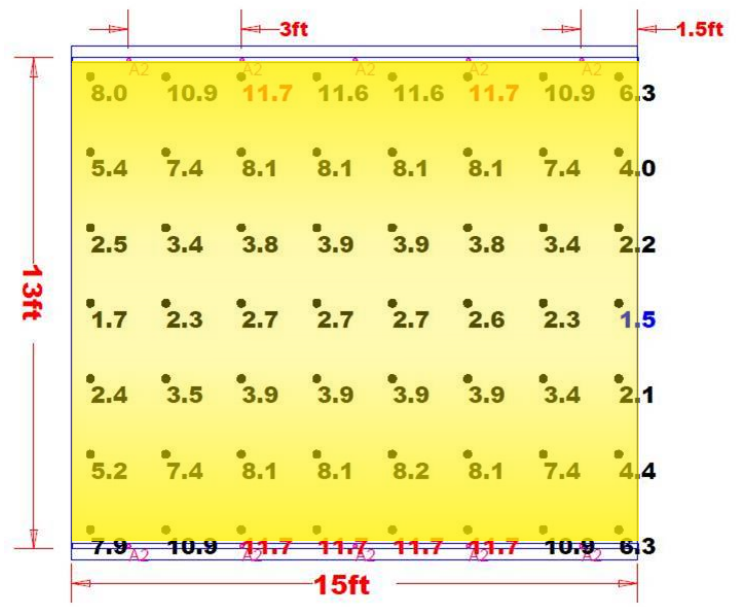

48" Between Fixtures:

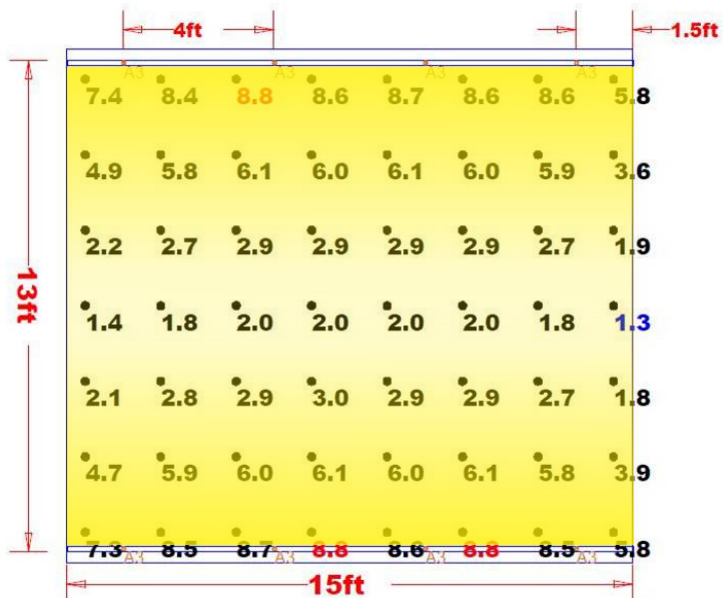

60" Between Fixtures:

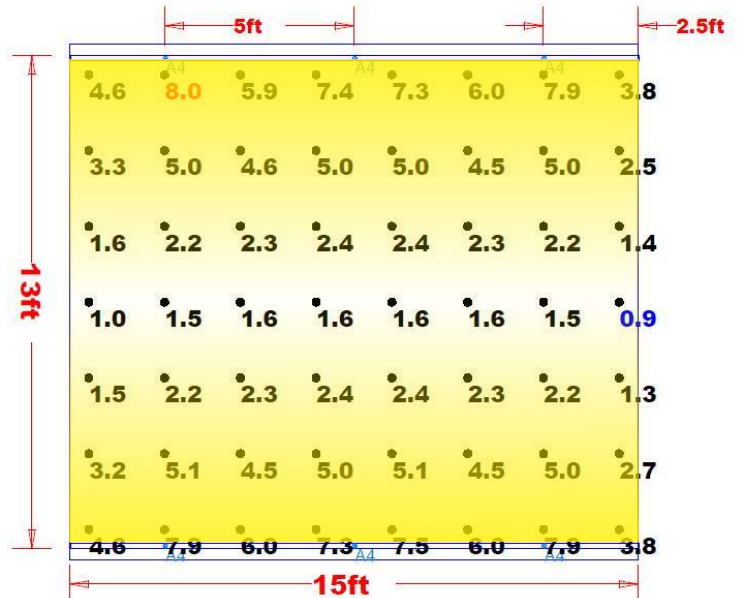

Project Name:

Location:

Specifier:

Rep Agency:

Fixture Type:

Product Code:

Installation Instructions Additional instructions may apply, consult factory.



Instruction Sheet
KLIK LEDpod™ XL28 Flat · 24VDC

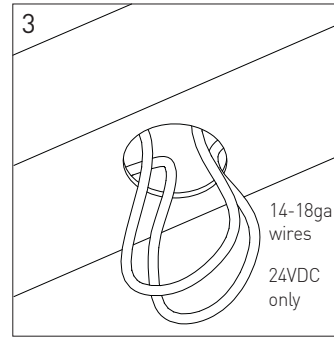
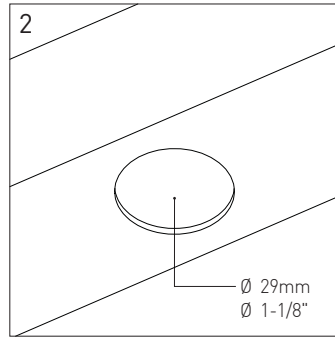
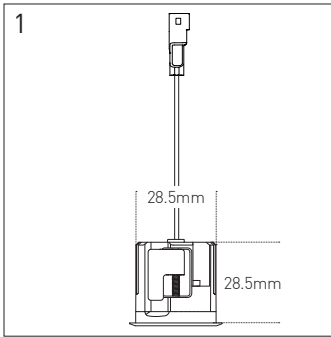

WARNING

- Risk of fire or electric shock.
- Disconnect all power before installing or servicing.
- Installation Instruction for qualified electricians only.
- Install per National Electrical Code and local regulations.
- Read Installation Instructions completely before installation.
- Failure to follow Installation Instructions may void warranties.

To reduce risk of electric shock turn off the electrical supply before installing or servicing the light fixtures and driver. Failure to do so may result in serious injury and/or damage to the components.

This product must be installed in accordance with the applicable installation code by a person familiar with the construction and operation of the product and the hazards involved.

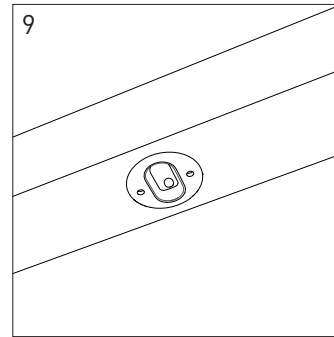
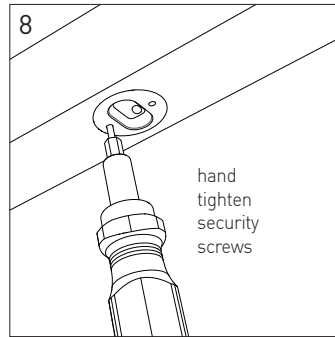
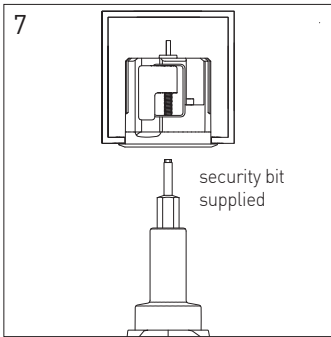
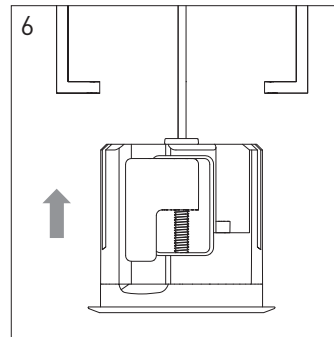
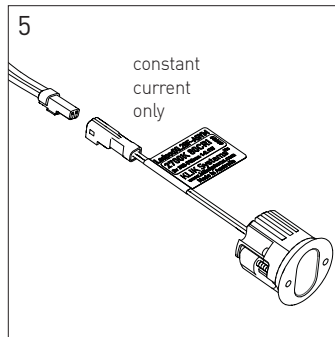
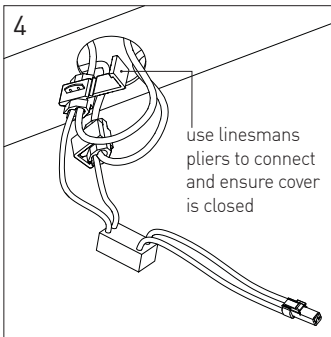

The light source contained in this luminaire shall only be replaced by the manufacturer or the service agent or a similar qualified person.

Project Name:

Location:

Specifier:

Rep Agency:

Fixture Type:

Product Code:

Installation Instructions

Additional instructions may apply, consult factory.



Instruction Sheet

KLIK LEDpod™ XL28 R35 · 24VDC

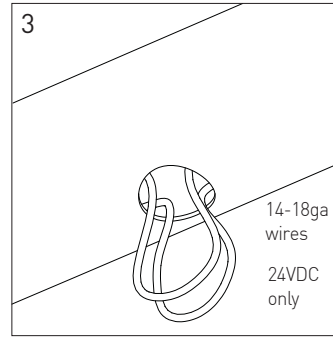
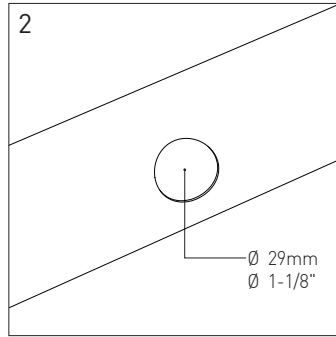
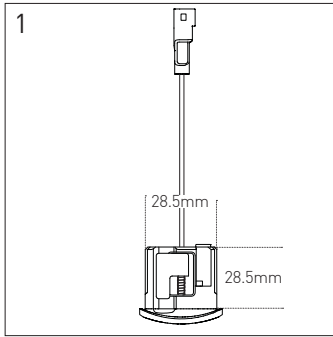

WARNING

- Risk of fire or electric shock.
- Disconnect all power before installing or servicing.
- Installation Instruction for qualified electricians only.
- Install per National Electrical Code and local regulations.
- Read Installation Instructions completely before installation.
- Failure to follow Installation Instructions may void warranties.

To reduce risk of electric shock turn off the electrical supply before installing or servicing the light fixtures and driver. Failure to do so may result in serious injury and/or damage to the components.

This product must be installed in accordance with the applicable installation code by a person familiar with the construction and operation of the product and the hazards involved.

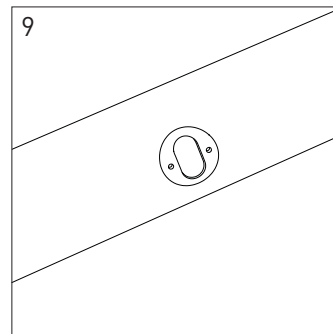
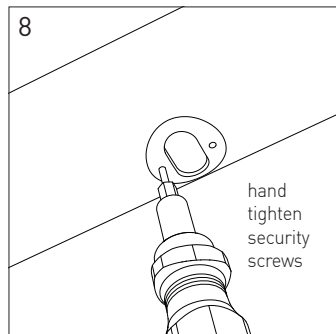
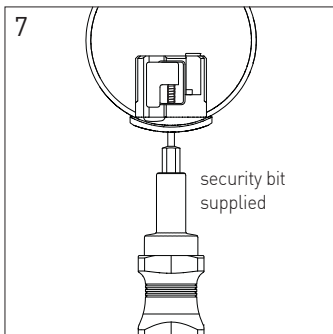
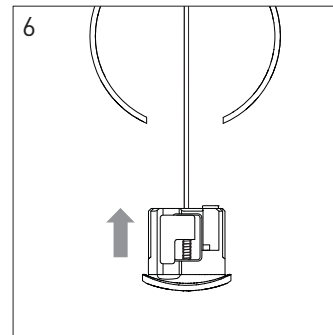
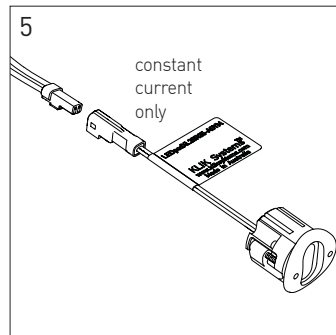
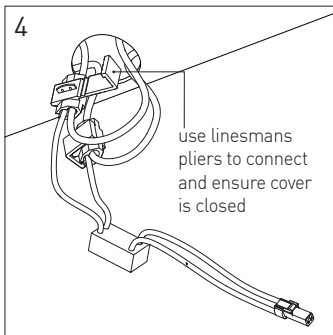

The light source contained in this luminaire shall only be replaced by the manufacturer or the service agent or a similar qualified person.

Project Name:

Location:

Specifier:

Rep Agency:

Fixture Type:

Product Code:

Installation Instructions

Additional instructions may apply, consult factory.



Instruction Sheet

KLIK LEDpod™ XL28 R40 · 24VDC

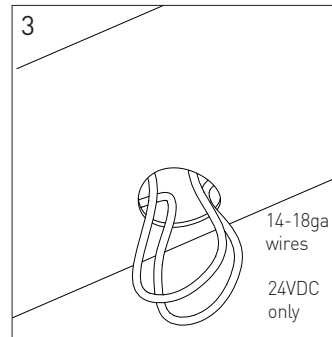
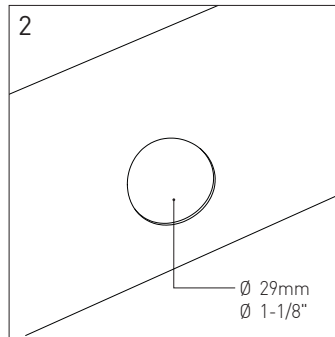
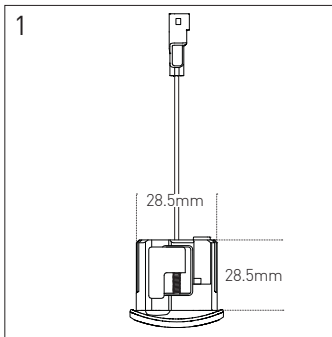

WARNING

- Risk of fire or electric shock.
- Disconnect all power before installing or servicing.
- Installation Instruction for qualified electricians only.
- Install per National Electrical Code and local regulations.
- Read Installation Instructions completely before installation.
- Failure to follow Installation Instructions may void warranties.

To reduce risk of electric shock turn off the electrical supply before installing or servicing the light fixtures and driver. Failure to do so may result in serious injury and/or damage to the components.

This product must be installed in accordance with the applicable installation code by a person familiar with the construction and operation of the product and the hazards involved.

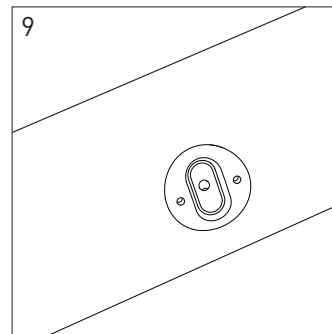
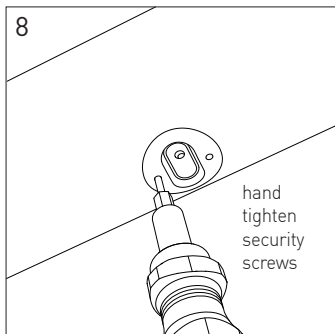
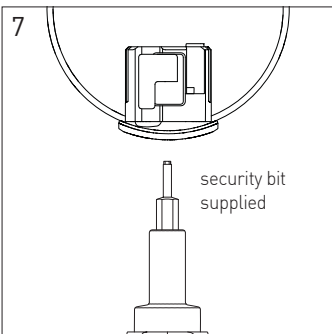
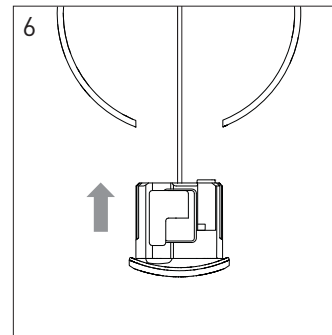
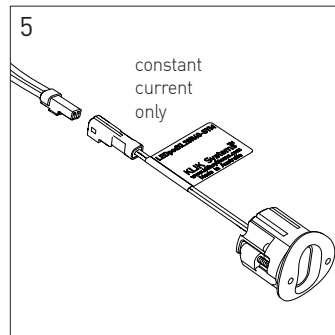
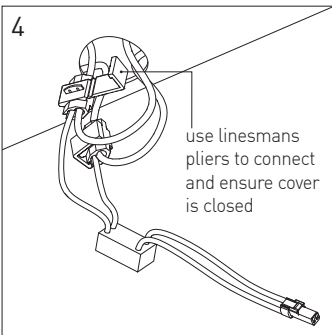

The light source contained in this luminaire shall only be replaced by the manufacturer or the service agent or a similar qualified person.

Project Name:

Location:

Specifier:

Rep Agency:

Fixture Type:

Product Code:

Wiring Diagram - Through Metal Structure

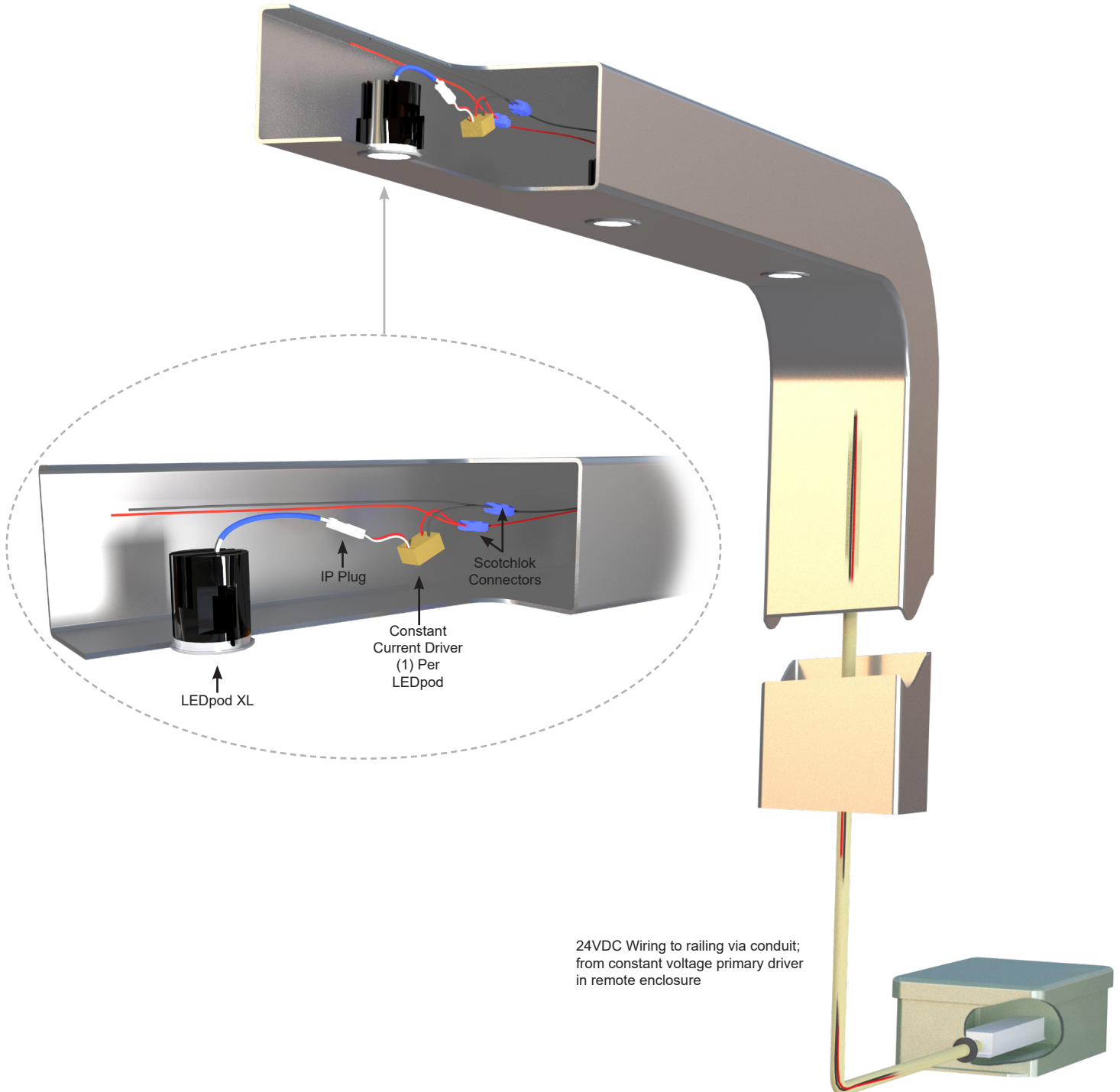

Project Name:

Location:

Specifier:

Rep Agency:

Fixture Type:

Product Code:

Wiring Diagram - Through Building

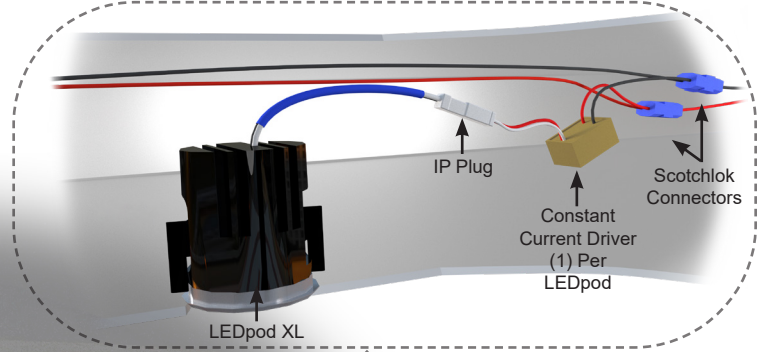

24VDC Wiring to railing via conduit;
from constant voltage primary driver
in remote enclosure

