

Project Name:

Location:

Specifier:

Rep Agency:

Fixture Type:

Product Code:

# KLIK LEDpod™ XL50 Patented

## Description

Minimalist point source LED fixture with multiple outputs for use in hollow metal structures such as guard rails, awnings, canopies and custom luminaires.

## Housing

Clear anodized aluminum body as standard. Color-match anodized as an option, consult factory.

Aluminum body has a fine 25-micron finish and is hard-coat anodized, thus preventing galvanic corrosion.

## Mounting

Unique concealed internal mounting wings hold the fixture in place, deployed via unobtrusive screw holes with patent-pending anti-tamper screws.

- Tube Size:
  - XL50 Flat: RHS min 2.75" height, Max. wall .3125"
  - XL50R50: Ø 3" - 5", Max. wall .3125"
  - XL50R85: Ø 6" - 8", Max. wall .3125"
  - Other sizes available upon request

- Cut Out: 48mm (1.90")
- Weight: 0.43 LBS

## Electrical/LED Driver

- Input Voltage: 24 VDC
- Operating Temp: -40 to 120° F
- Efficiency: Up to 120 lm/W
- Driver: Must use class 2 driver
  - Primary Driver: 110 - 277 VAC UL Listed Constant Voltage
  - Secondary Driver: Constant Current (provided with fixture)
- Control: DALI, 0-10V, DMX
  - DMX control typically for dimming only; Contact factory for addressable and RGBW options
- Enclosure: Minimum NEMA 3R required
- Wire connectors provided; factory wire-harness available, consult factory

## Listings

- ETL listed, UL 1598/CSA 22.2; CE
- cETL
- IP65 rated All IP rated luminaires tested to AS60529-2004 Degrees of protection provided by enclosures (IP Code)
- Class 3 device
- Wet location rated

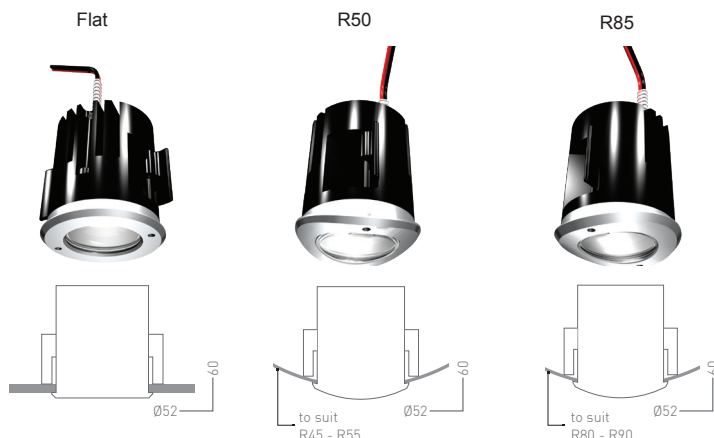

Commack Library Photo by Ola Wilk/  
Wilk Marketing Communications

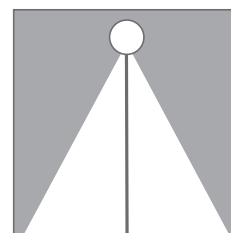

Symmetric



## Product Codes

Follow the steps to specify your fixture. Enter Product Code in field at top of page. Example: LPXL50F0027K2.3SSPT

Fixture Type	Size	Bezel Profile	Color	Wattage	Distribution	Optic	Lens	Dimming <sup>1</sup>	Custom Bezel <sup>1,2</sup>
LPXL LEDpod XL	50 Drill 1.90" Hole	F00 Flat R50 50mmR R85 85mmR	27K 2700K	2.3 2.3 Watts	S Symmetric	SPT Spot	Clear lens standard FRS Frosted	DIM Dimmable	RAL Custom Powdercoat
			30K 3000K	3.2 3.2 Watts		NFL Narrow Flood			ANO Color Anodize
			35K 3500K	4.5 4.5 Watts		FLD Flood			
			40K 4000K	6.6 6.6 Watts		SPTRFL Spot Reflector			
			50K 5000K	7.5 7.5 Watts		NFLRFL Narrow Flood Reflector			
			RED Red	FLDRFL Flood Reflector					
			GRN Green						
			BLU Blue						
			AMB Amber						
			PCA PC Amber						
			RGB RGBW <sup>2</sup>			SHR Diode shroud for horizontal mount			

1. Additional charges and lead time apply for this feature.

2. Contact factory

Project Name:	Location:
Specifier:	Rep Agency:
Fixture Type:	Product Code:

## LED Performance

LED: Cree XT-E  
CCT: 2700, 3000, 4000 (others available)

CRI: 80-85  
Life: 80% at 50k hrs and 85° C

Binning: 3 MacAdam Steps  
Warranty: 5 Year Warranty

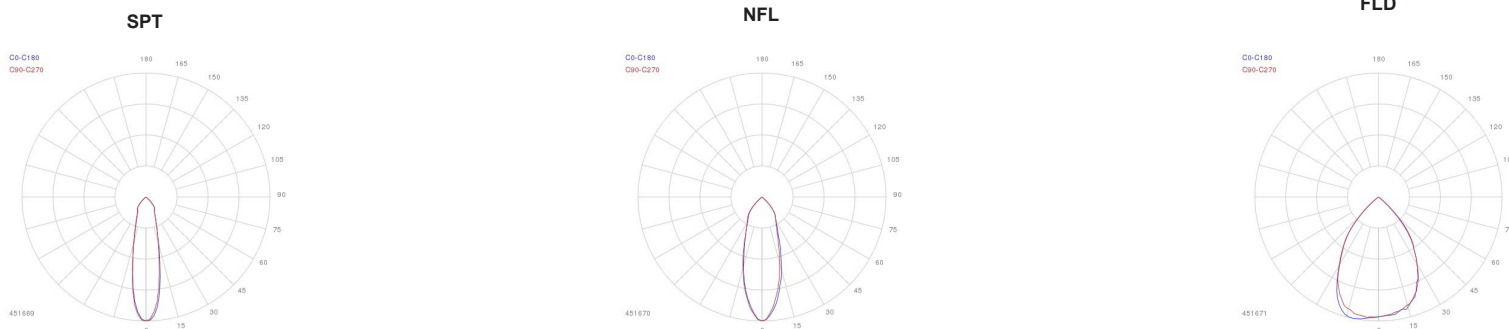

Optics			Lens			Reflector		
Beam Angle			SP spot 26°	NFL narrow flood 32°	FL flood 62°	SP spot 24°	NFL narrow flood 30°	FL flood 64°
LOR defined by optics			78	77	78	90	87	88
lm	w	mA	System Lumens @4000K					
300	2.3	350	234	231	234	270	260	264
375	3.1	500	293	289	293	338	325	330
525	4.4	700	410	405	410	473	456	462
690	6.3	1000	539	532	539	621	600	607
810	7.5	1200	632	624	632	729	704	712

## Remote Mounting Distance

### 24 VDC 100W Driver:

- Up to 300' remote length from driver to first LED w/10ga wire
- Contact factory for detailed calculations
- Calculations based on 2' centers between pods at 700mA (2.5W).
- Increased spacing reduces number of pods per circuit.

## Primary Driver

## Secondary LED Driver

## Spacing

## Maximum KLIK LEDpods™ \*

110 - 277 Primary Voltage Remotely Mounted Dimming Control 10" x 1.5" x 2"	1200mA	8'	9
	1000mA	8'	12
	700mA	8'	18
	500mA	8'	24
	350mA	8'	32

\*Based on 16 AWG between LEDpods

## Accessories

LP100WPRITRND	Class 2 Driver, Non-Dimming, Input voltage = 120-277 VAC, Output voltage = 24 VDC, 5 year warranty	Used for non-dimming KLIK LEDpods
LP100WPRITRNDIM	Class 2 Driver, Dimming, Input voltage = 120-277 VAC, Output voltage = 24 VDC, 5 year warranty	Used for dimming KLIK LEDpods
LPNEMA3RENCL	NEMA 3R Drip Proof Enclosure, 4" x 4" x 18" (IP32 Equivalent)	
LPNEMA4ENCL	NEMA 4 Watertight Enclosure, 14" x 8" x 6" (IP66 Equivalent)	
LPNEMA6PENCL	NEMA 6P Submersible Enclosure 15" x 8" x 6" (IP67 Equivalent)	

Additional driver & enclosure configurations available

Project Name:

Location:

Specifier:

Rep Agency:

Fixture Type:

Product Code:

**Installation Instructions** Additional instructions may apply, consult factory.



## Instruction Sheet

### LEDpod XL50 · 24VDC

**Dimensions**  
Ø 52 · h 60  
**Weight**  
0.088kg/m

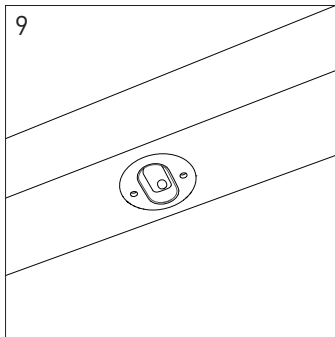
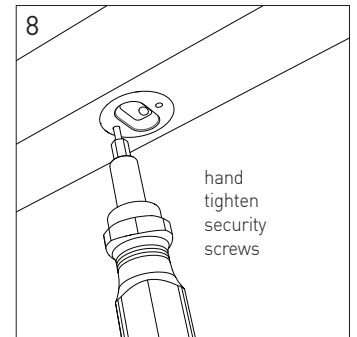
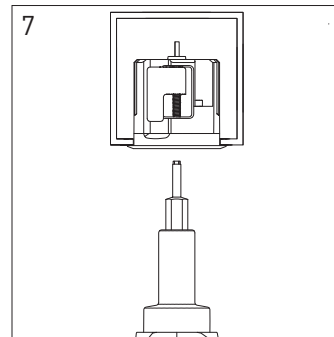
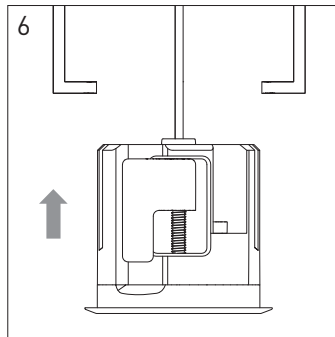
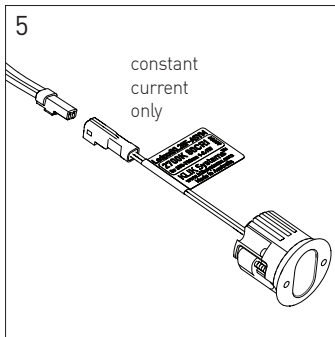
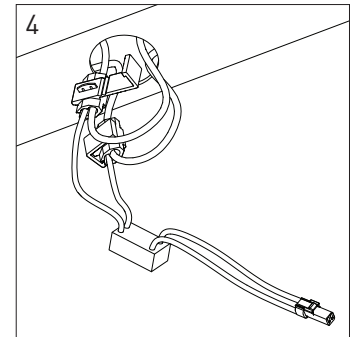
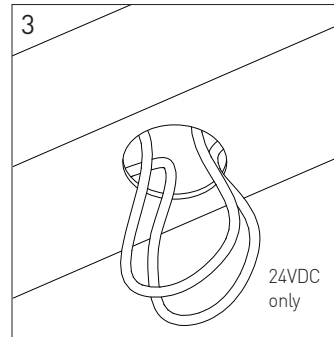
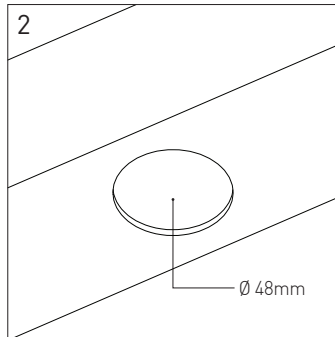
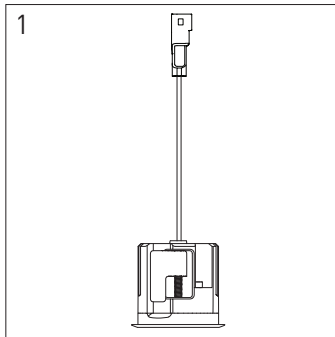

Project Name:

Location:

Specifier:

Rep Agency:

Fixture Type:

Product Code:

### Wiring Diagram - Through Metal Structure

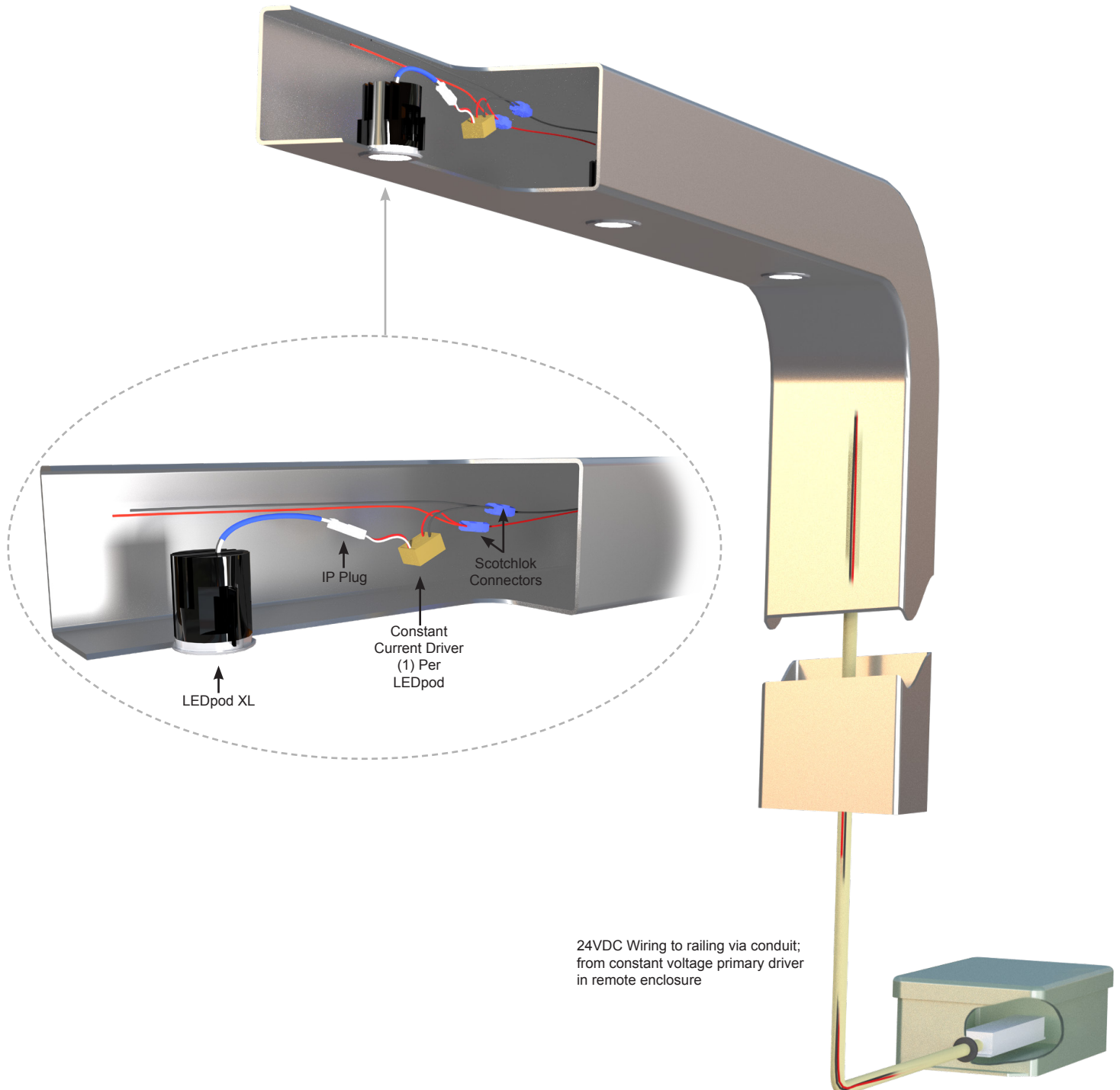



Project Name:

Location:

Specifier:

Rep Agency:

Fixture Type:

Product Code:

### Wiring Diagram - Through Building

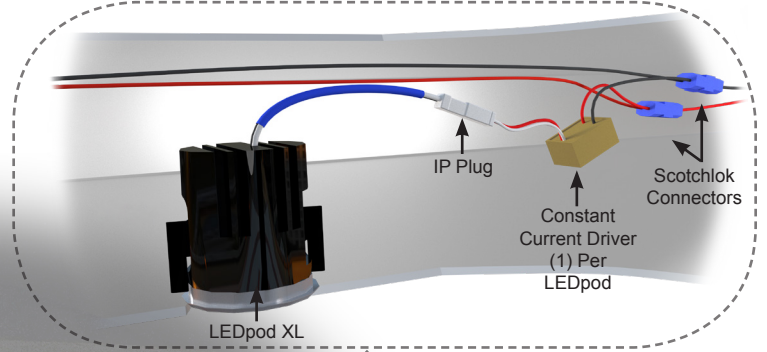

24VDC Wiring to railing via conduit;  
from constant voltage primary driver  
in remote enclosure

