

# MISTIK028 REC **SPEC**SHEET

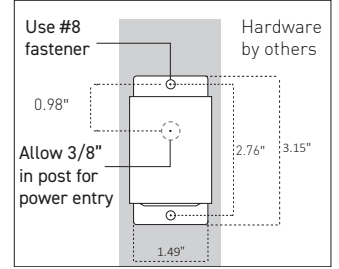

POST DIAMETER  
Ø38 · Ø42 · Ø48

38 SQ

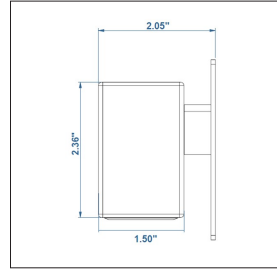

Optics			Reflector	
Beam Angle			symmetrical	asymmetrical
lm	W	mA	System Lumens <sup>1</sup>	
165	1.4	350	126	123
235	2	500	179	174
284	2.5	700	216	211
<b>Colour</b>	2200K · 2700K · 3000K · 4000K · 5000K · Red · Green · Blue · Amber · PC Amber			
<b>CRI</b>	80-85			
<b>Binning</b>	2 McAdam Step			
<b>Driver</b>	Output 350 - 700mA Constant Current (Provided with fixture based on selected wattage; Compatible with KLIK 24VDC power supply)			
<b>Control</b>	0-10V · DMX* · DALI			
<b>Mounting</b>	By others · 0.26in hole provided top and bottom for surface mounting			
<b>Distribution</b>	symmetric · asymmetric · soft symmetric · soft asymmetric · frost symmetric · frost asymmetric			
<b>Weight</b>	0.1lbs			

\* DMX control is for overall dimming only and not for individually addressed LEDpods  
1 Lumen output based on 4000K

MTK028KAPSD 20200904

## Product Codes

Follow the steps to specify your fixture. Enter Product Code in field at top of page. Example: **MKRC22KA500FL**

Fixture Type	Color <sup>1</sup>	Distribution	Wattage	Lens <sup>2,4</sup>	Mounting	Custom Bezel <sup>3,4,5</sup>
<b>MKRC</b>	<b>22K</b> 3000K	<b>A</b> Asymmetric	<b>350</b> 1.4 Watts	-- Clear Flood (Standard)	<b>FL</b> Flat Surface	<b>DUL</b> DULUX Colors (request color guide)
	<b>27K</b> 2700K	<b>S</b> Symmetric	<b>500</b> 2.0 Watts	<b>FR</b> Frosted	<b>P38</b> 1.5" OD post	<b>RAL</b> RAL #
	<b>30K</b> 3000K		<b>700</b> 2.5 Watts	<b>SF</b> Light Filter	<b>P42</b> 1.66" OD post	
	<b>35K</b> 3500K				<b>P48</b> 1.90" OD post	
	<b>40K</b> 4000K					
	<b>50K</b> 5000K					
<b>AMB</b> Amber						
<b>PCA</b> Phosphor-Converted Amber						

1. Other colors on request.  
2. Clear FLD (Flood lens standard; FRS is heavy opaque; SFT is light filter).  
3. Specify RAL# (Additional charge)  
4. **Additional charges and lead time apply for this feature.**  
5. Colored anodized bezel available, contact factory

