

# EKKO 026 BEAM SPEC SHEET

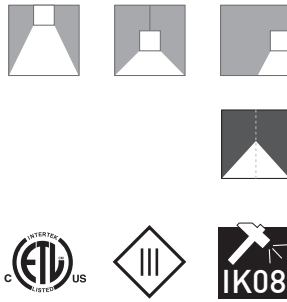

Project Name:
Specifier:
Location:
Product Code:

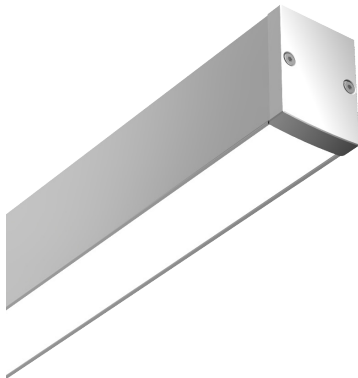
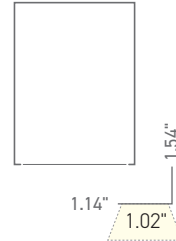

DIRECT	LEDoptek			
LED Lumens/m (L/f)	500 (152)	1000 (300)	1500 (455)	2250 (682)
Delivered Lumens/m (L/f)	320 (97)	640 (194)	960 (291)	1440 (436)
Standard CRI	>80			
System W/m (W/f)				
2700K	4 (1.2)	8 (2.4)	13 (3.9)	21.7 (6.6)
3000K	4 (1.2)	7.9 (2.4)	12.5 (3.8)	21.7 (6.6)
3500K	4 (1.2)	7.6 (2.3)	12 (3.6)	20 (6.1)
4000K	4 (1.2)	7.7 (2.3)	12 (3.6)	19.6 (5.9)
Other LED Options	5000K · RGBW · tuneable white · cyanosis · high CRI 98 R9 > 80			
Control (Remote)	non dim · DALI · Casambi · 0-10V · DMX (RGBW only)			
Optics	LEDoptek - symmetrical			
Finish	white/black/silver powder coat standard · custom powder coat · clear anodized			
Weight/Pack Size	0.9kg/m - 70 x 70 x (l + 200mm)			
Mounting	wire suspended · rod suspended · surface mount bracket · wall mount bracket			
Accessories	mitred bends · T-joins			
Luminaire Length	any length over 500mm in 1mm increments with fully illuminated diffuser			

1. Lumens/m based on 4000K LED strip

EKK026BMD-LEDoptek-20201124-01

Product Codes		Follow the steps to specify your fixture. Enter Product Code in field at top of page. Example: EKK0026BMD___30K500ANONON											
Fixture Type	Aperture Size	Form	Mounting	Nominal Length	Color	Output (lm/m)	Finish	Control	Bends				
EKKO	026 26mm	BMD Beam Direct	SUR Surface CAB Cable Susp ROD Suspension Rod WALL Wall-mount REC Recessed Flush		27K 2700K 30K 3000K 35K 3500K 40K 4000K TUN Tunable White RGB RGBW CRI 98CRI R9>80 CUS Custom (consult factory)	500 1000 1500 2250	ANO Clear Anodized PCB Powdercoat Black PCS Powdercoat Silver PCW Powdercoat White CUS Custom (consult factory)	NON Non-Dim 0-10 0-10V Dim DALI DALI DMX RGB Only	BND If miters req'd, provide drawing				

1. Specify cable termination at mounting point

2. Specify mounting length

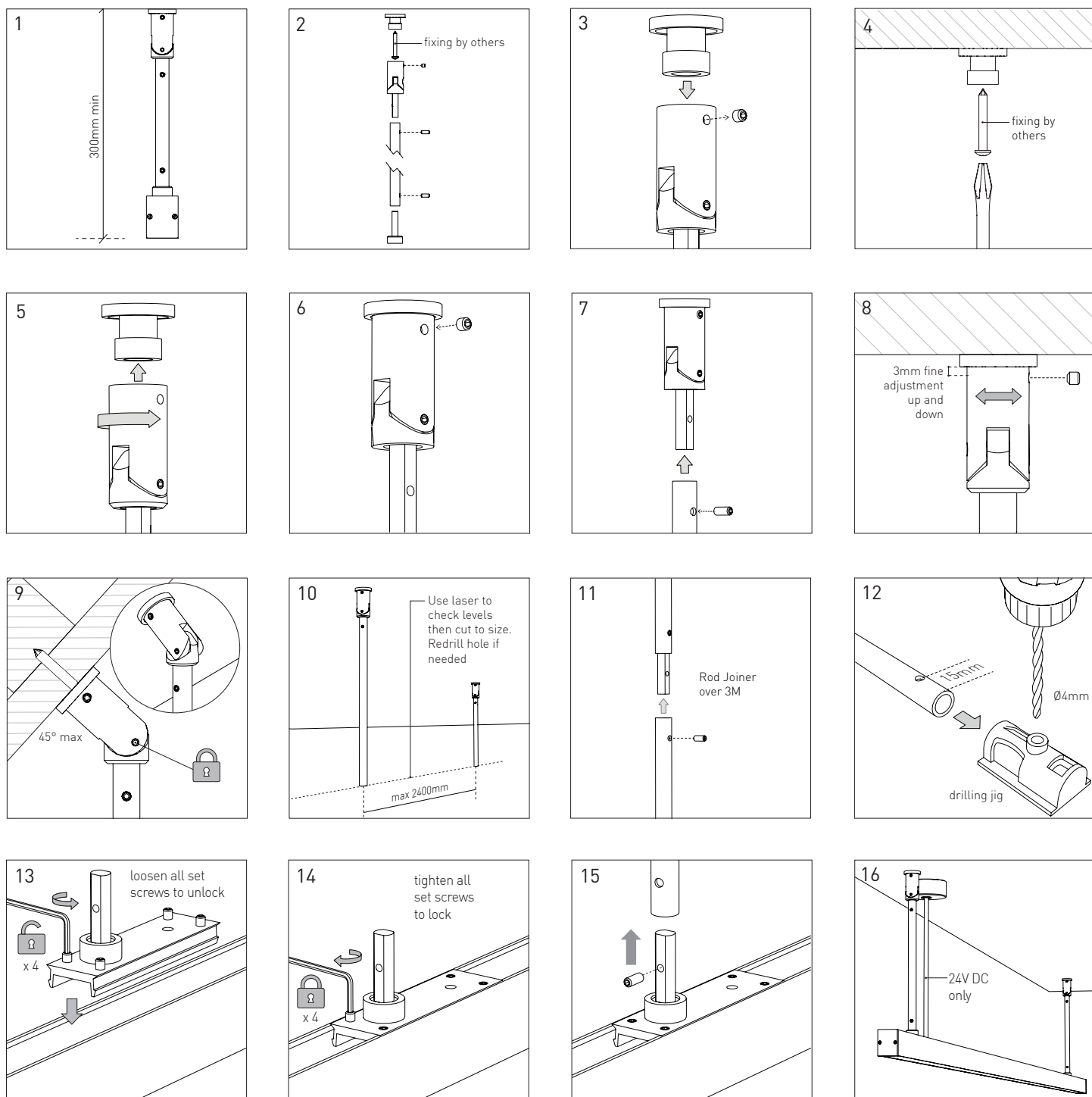

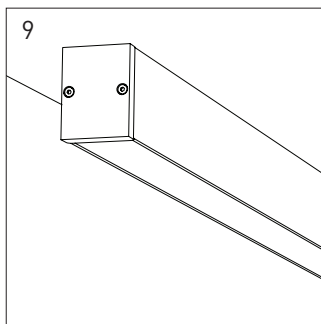
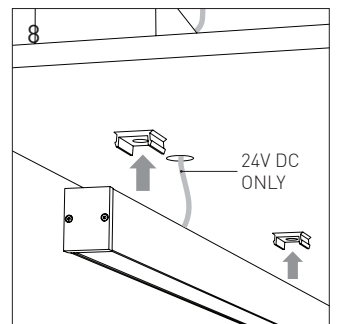
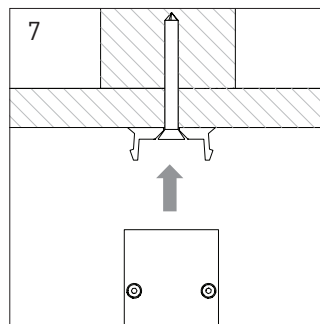
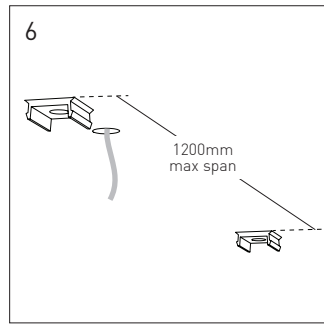
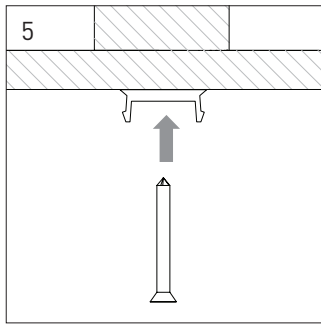
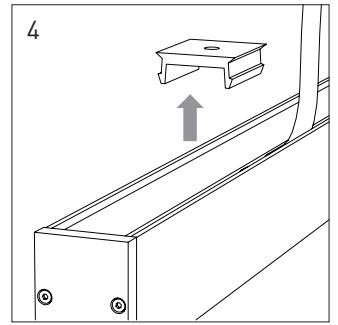
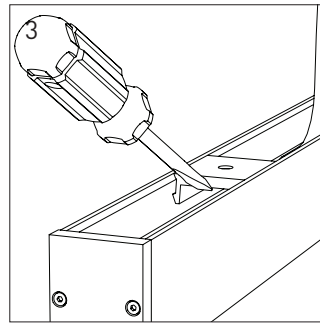
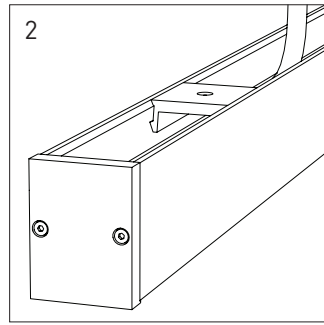
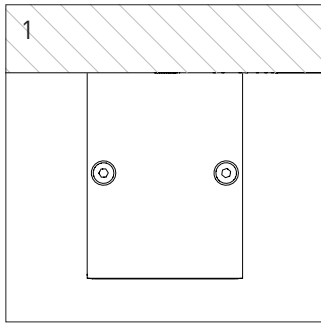

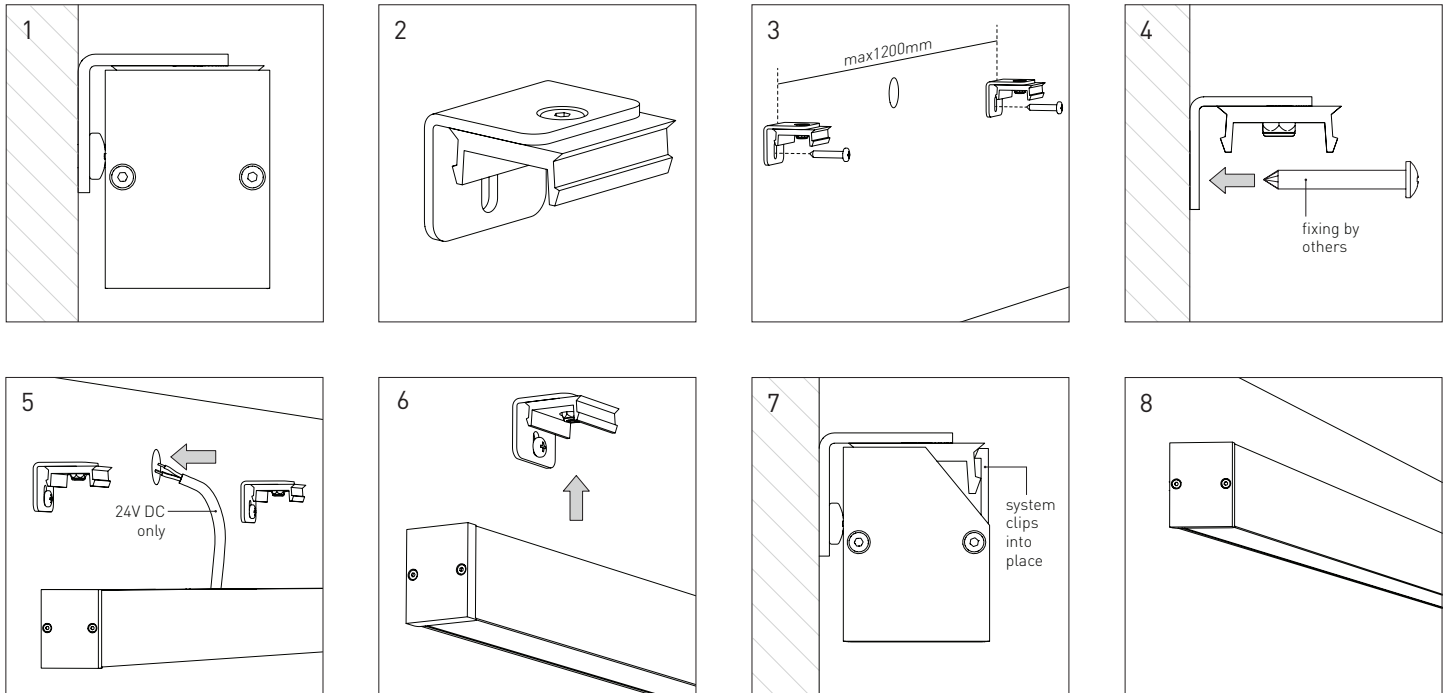

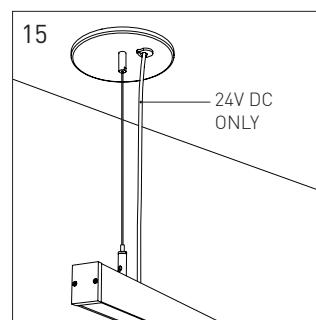
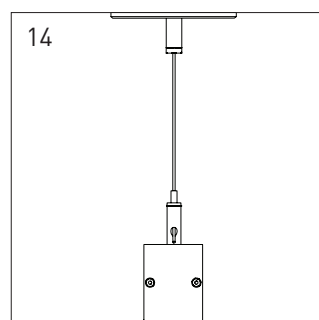
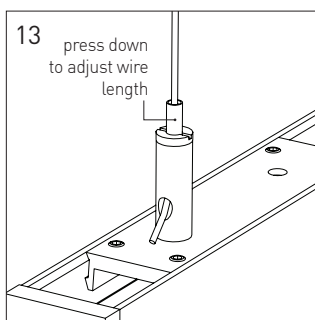
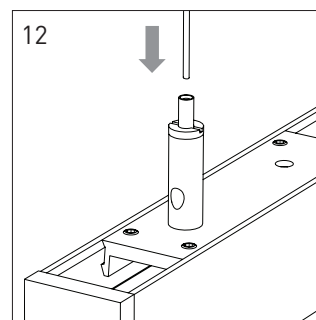
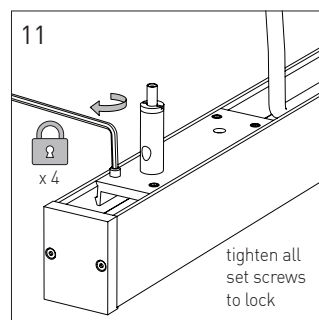
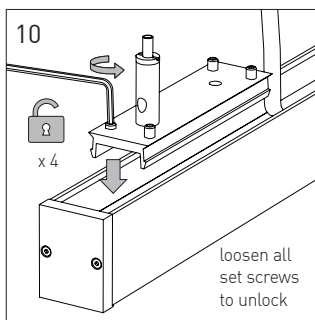
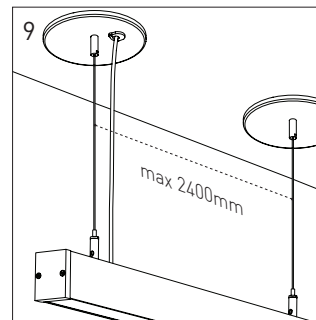
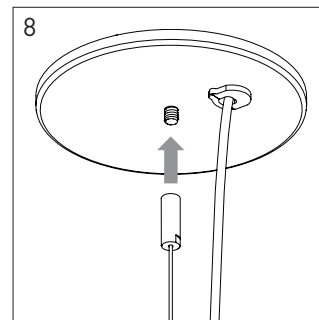
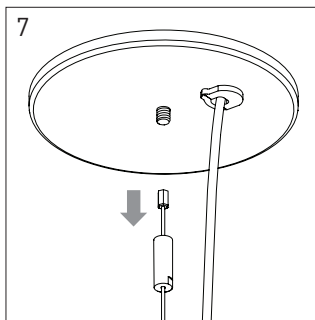
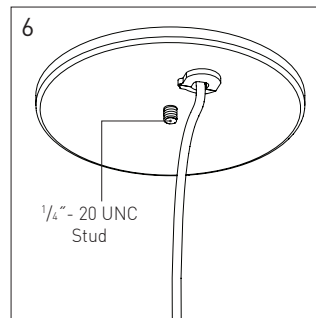
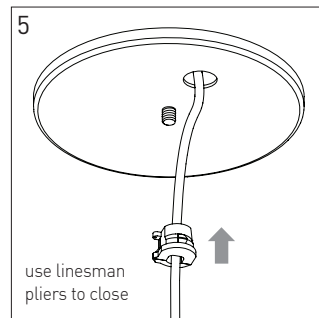
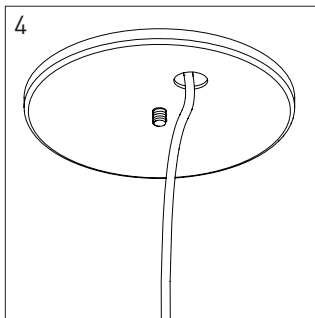
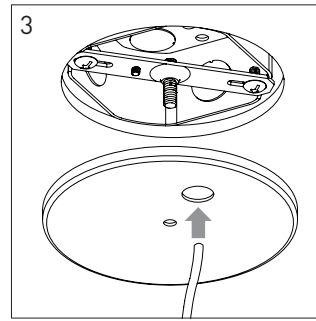
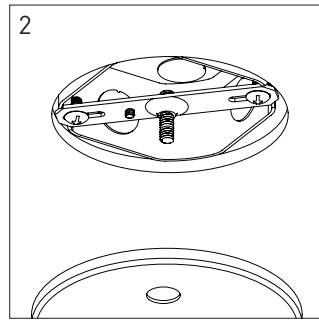
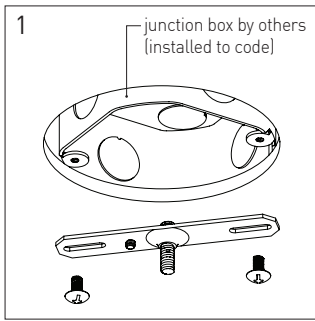

## WARNING

- Risk of fire or electric shock.
- Disconnect all power before installing or servicing.
- Installation Instruction for qualified electricians only.
- Install per National Electrical Code and local regulations.
- Read Installation Instructions completely before installation.
- Failure to follow Installation Instructions may void warranties.

To reduce risk of electric shock turn off the electrical supply before installing or servicing the light fixtures and driver. Failure to do so may result in serious injury and/or damage to the components.

This product must be installed in accordance with the applicable installation code by a person familiar with the construction and operation of the product and the hazards involved.

## FIXINGS (BY OTHERS)

Appropriate fixings to be selected based on the ceiling type or supporting member. Fasteners and anchors shall be rated at greater than four times the weight of the luminaire that it is supporting.

## MAXIMUM SPACING

2400mm

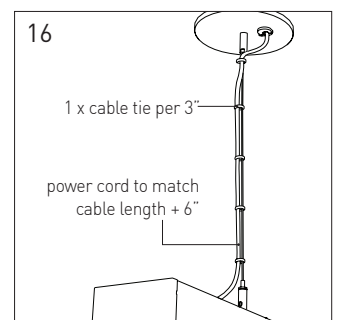

The light source contained in this luminaire shall only be replaced by the manufacturer or the service agent or a similar qualified person.

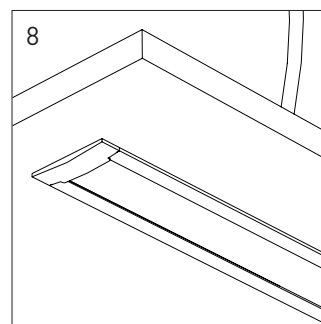
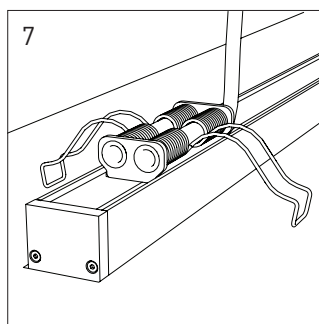
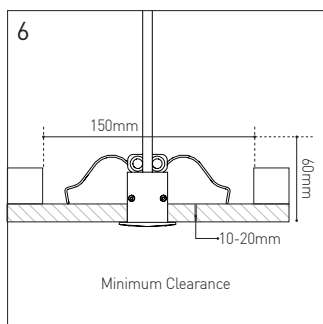
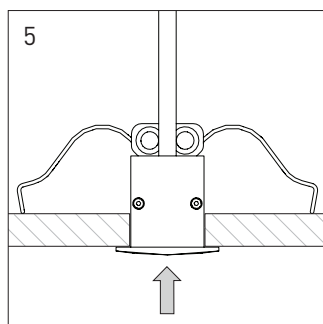
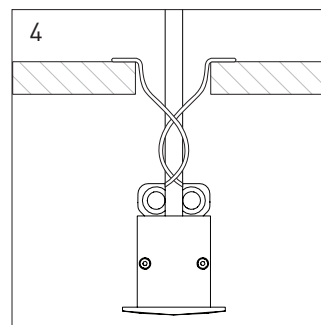
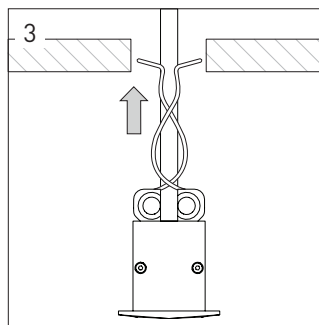
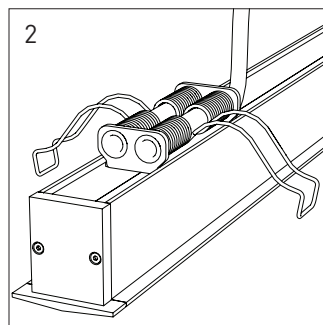
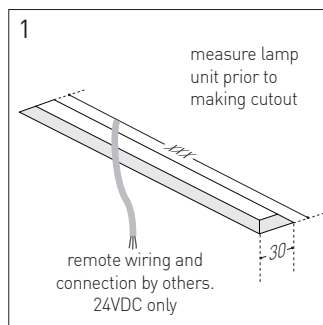

















## INSTRUCTION SHEET: DMX CONNECTION

All KLIK DMX controlled linear products are supplied with Cat5/6 cables supporting DMX transmission. Each fitting is supplied with a labelled DMX IN and DMX OUT (if required) RJ45 Socketed cable.

The pinouts are wired as per Table 4 Section 7.3 of E1.11 – 2008, USITT DMX 512-A. (TABLE 1)

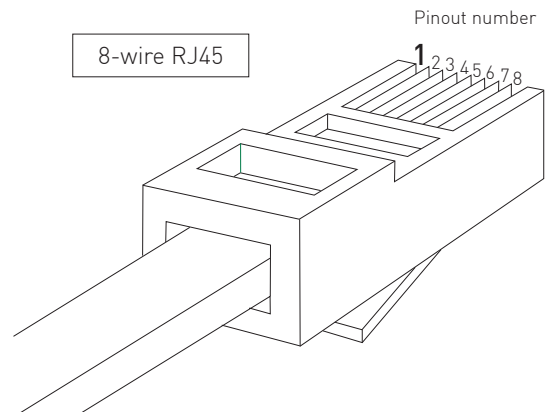

TABLE 1

(Wire) #	DMX512 Function	T568B Wire Colour	T568A Wire Colour
1	Data 1 +	White/ Orange 	White/ Green 
2	Data 1 -	Orange 	Green Pin 
3	Data 2 + (Not utilised)	White/ Green 	White/ Orange 
4	Data 2 - (Not utilised)	Blue 	Blue 
5	Not assigned	White/ Blue 	White/ Blue 
6	Not assigned	Green 	Orange 
7	Data Link Common	White/ Brown 	White/ Brown 
8	Data Link Common	Brown 	Brown 
	Drain		

**Klik fittings are configured internally or in a remote box as follows:**

- All DMX controllers are supplied with optically isolated receivers.
- Multiple DMX controllers (Nodes) are wired internally as a daisy chain. Each node has a 1 in, 2 out splitter. KLIK DMX nodes do not need to be terminated with a 120Ω resistor.
- These Nodes may be wired internally with CAT 5 cable or a 3 core cable. Internal DMX wiring of KLIK fittings are propriety and may not conform to Table 4 Section 7.3 of E1.11 – 2008, USITT DMX 512-A. Any alteration to internal DMX wiring is not covered by KLIK warranty. It is suggested that if any modifications are to be made that a KLIK technician be contacted first.
- Unless otherwise specified all Nodes are factory set to DMX start channel 1. To alter the start address of a Node, physical access to the Node is required. The Node also requires a supply voltage to re-address the DMX controller. DMX-RDM is not supported in standard KLIK fittings.
- If multiple addresses are KLIK factory set, then these addresses will be labelled on the Node and on the fitting. Note: It is not necessary to daisy chain addressed fixtures in numerical order.
- KLIK DMX Nodes are designed to be daisy chained across multiple KLIK fittings without the need for external DMX Splitters.
- KLIK DMX fittings should never be wired in a star topology. Fittings shall be daisy chained connecting DMX OUT labelled cables to the next DMX IN labelled cable. If a star type topology is required then a DMX Splitter shall be used.
- Any external DMX wiring (CAT5/6) installed by the contractor shall be segregated and cross other power lines at a 90° angle.
- On KLIK suspended products the length of the Cat5/6 cables (IN/OUT) will be the same as the power feeds and will be grey.
- No other data or power is to be connected to the DMX IN or DMX OUT connections.





# INSTRUCTION SHEET: DMX CONNECTION

## KLIK DMX internal wiring diagram

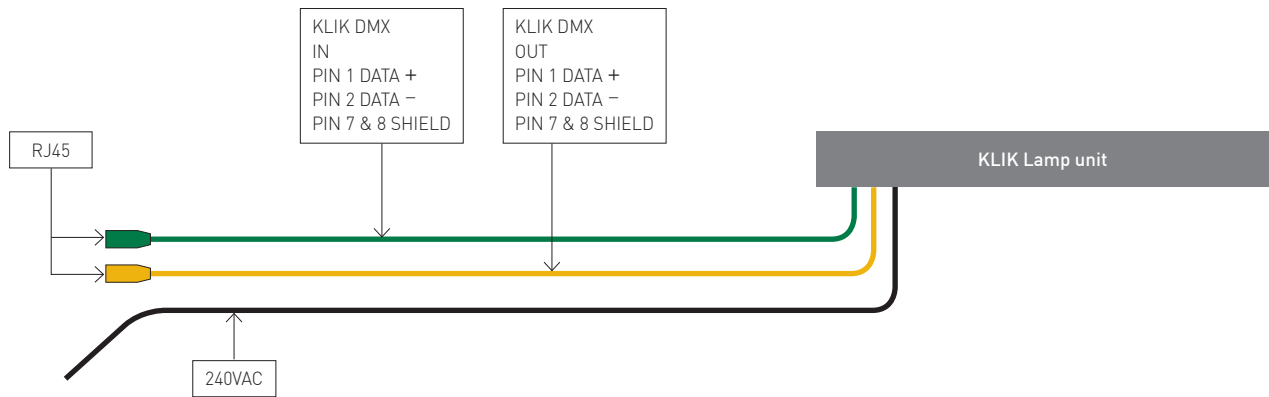

## KLIK DMX remote wiring diagram

