

MISTIK028 REC **SPEC**SHEET

POST DIAMETER
Ø38 · Ø42 · Ø48

38 SQ

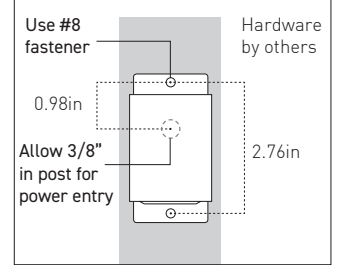
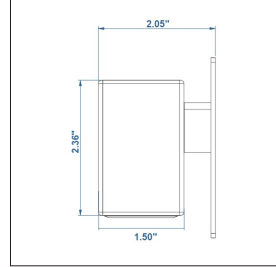

Optics			Reflector	
Beam Angle			symmetrical	asymmetrical
lm	W	mA	System Lumens ¹	
165	1.4	350	126	123
235	2	500	179	174
284	2.5	700	216	211
Colour			2200K · 2700K · 3000K · 4000K · 5000K · Red · Green · Blue · Amber · PC Amber	
CRI			80-85	
Binning			2 McAdam Step	
Driver			Output 350 - 700mA Constant Current (Provided with fixture based on selected wattage; Compatible with KLIK 24VDC power supply)	
Control			0-10V · DMX* · DALI	
Mounting			By others · 0.26in hole provided top and bottom for surface mounting	
Distribution			symmetric · asymmetric · soft symmetric · soft asymmetric · frost symmetric · frost asymmetric	
Weight			0.1lbs	

* DMX control is for overall dimming only and not for individually addressed LEDpods
1 Lumen output based on 4000K

MTK028KAPSD 20200904

Product Codes

Follow the steps to specify your fixture. Enter Product Code in field at top of page. Example: **LPMISTIK028CYL30KA2.0WFLD**

Fixture Type	Color ¹	Distribution	Wattage	Lens ^{2,4}	Mounting	Custom Bezel ^{3,4,5}
LPMISTIK028 REC	22K 2200K 27K 2700K 30K 3000K 35K 3500K 40K 4000K 50K 5000K AMB Amber PCA Phosphor-Converted Amber	A Asymmetric S Symmetric	1.4W 1.4 Watts 2.0W 2.0 Watts 2.5W 2.5 Watts	FLD Clear Flood (Standard) FRS Frosted SFT Light Filter	FLT Flat Surface P38 1.5" OD post P42 1.66" OD post P48 1.90" OD post	DUL DULUX Colors (request color guide) RAL RAL #

- Other colors on request.
- Clear FLD (Flood lens standard; FRS is heavy opaque; SFT is light filter).
- Specify RAL# (Additional charge)
- Additional charges and lead time apply for this feature.
- Colored anodized bezel available, contact factory

